

SHELBOURNE

— ESTATES —



The Harbury

Displaying instant classic charm, The Harbury stands tall and proud as a fantastic family home. Complementing its fine architecture is a modern and spacious interior that is carefully designed around today's lifestyle, with an open plan kitchen area and grand bi-fold doors leading to the garden and creating a light and spacious environment.

4 Bedrooms

1,462 TOTAL SQ FT

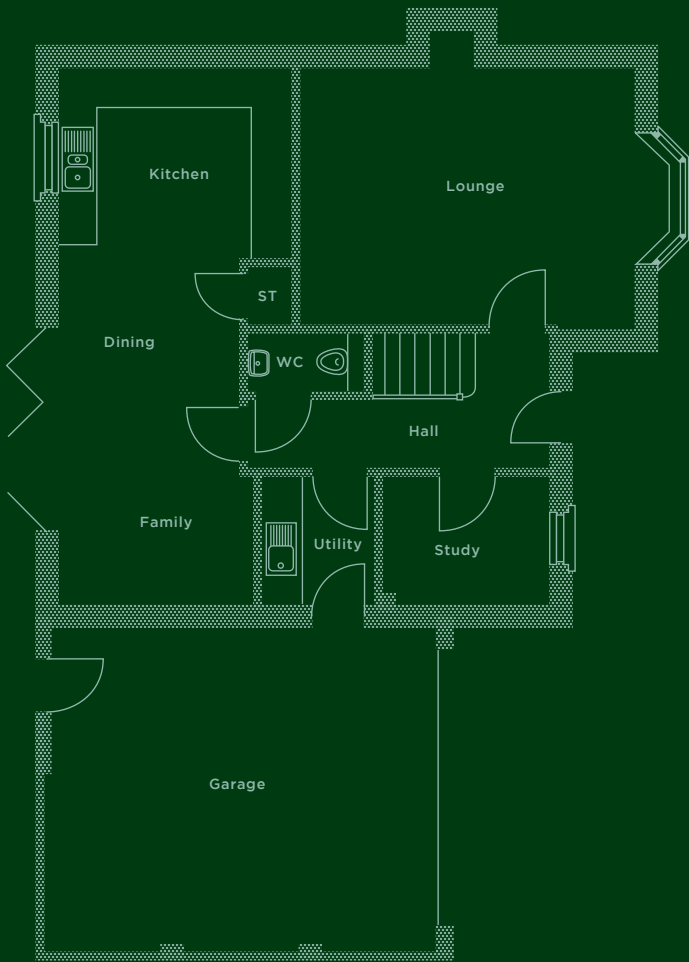

Downstairs

Lounge	4000 x 5625*mm 13'1" x 18'5"*
Family/Dining/ Kitchen	8200 x 3550*mm 26'11" x 11'8"*
Study	1950 x 2550mm 6'5" x 8'4"
Cloaks/WC	890 x 1710mm 2'11" x 5'7"
Utility	1950 x 1700mm 6'5" x 5'7"

Upstairs

Bedroom 1	3970 x 3850*mm 13'0" x 12'8"*
Ensuite 1	2910* x 1925*mm 9'7"* x 6'4"*
Bedroom 2	4155* x 4350*mm 13'7"* x 14'3"*
Ensuite 2	1915 x 1475mm 6'3" x 4'10"
Bedroom 3	2910 x 3165mm 9'7" x 10'5"
Bedroom 4	2735* x 3065*mm 9'0"* x 10'1"*
Bathroom	2375* x 1960*mm 7'10"* x 6'5"*

*Denotes maximum room dimensions.

