

SHELBOURNE
— ESTATES —



The Oxhill

The Oxhill stands tall and proud as a fantastic family home. Complementing its fine architecture is a modern and spacious interior that is carefully designed around today's lifestyle, with an open plan kitchen area and grand bi-fold doors leading to the garden and creating a light and spacious environment.

4 Bedrooms

1,498 TOTAL SQ FT

Downstairs

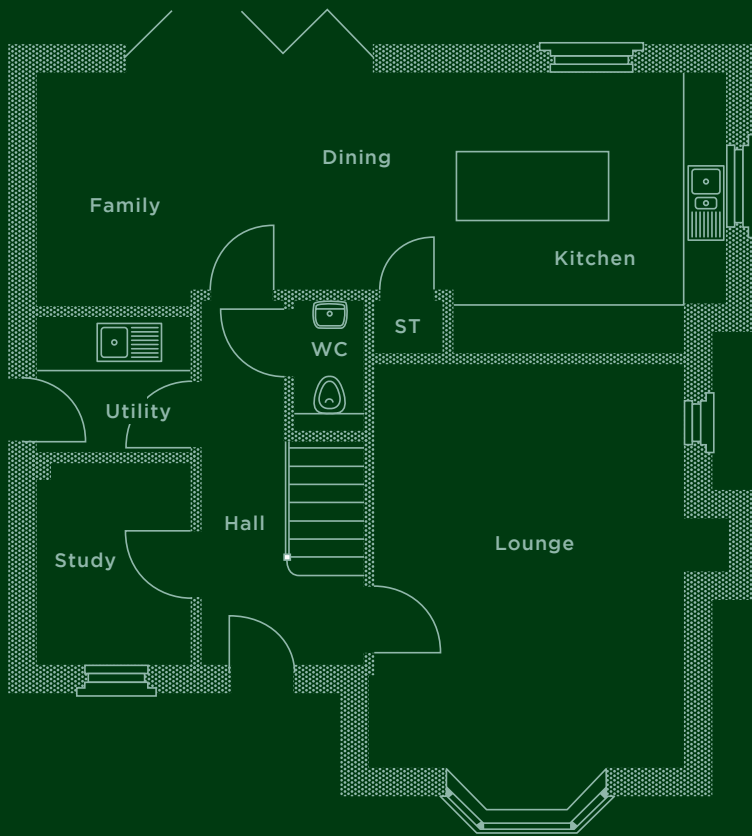

Lounge	5600* x 4000*mm 18'4"* x 13'1"*
Family/Dining/ Kitchen	3550* x 8750*mm 11'8"* x 28'8"*
Study	2550 x 1950mm 8'4" x 6'5"
Utility	1700 x 1950mm 5'7" x 6'5"
Cloaks/WC	880 x 1700mm 2'10" x 5'7"

Upstairs

Bedroom 1	3835* x 4000mm 12'7"* x 13'1"
Ensuite 1	2900* x 1900*mm 9'6"* x 6'3"*
Bedroom 2	4335* x 4140*mm 14'3"* x 13'7"*
Ensuite 2	1900 x 1450mm 6'3" x 4'9"
Bedroom 3	3450* x 3150mm 11'4"* x 10'4"
Bedroom 4	2725* x 3050*mm 8'11"* x 10'0"*
Bathroom	2350 x 1950mm 7'9" x 6'5"

*Denotes maximum room dimensions.

