

SHELBOURNE

— ESTATES —



The Napsbury

The Napsbury is a truly spacious family home, the ground floor has a sizeable lounge and separate open plan kitchen/dining and family room with large bi-fold doors leading to the garden, as well as under stair storage space.

A first floor master bedroom has an en-suite bathroom, while three additional bedrooms and a shared bathroom help to complete the feel of a comfortable and roomy home.

4 Bedrooms

1,487 TOTAL SQ FT

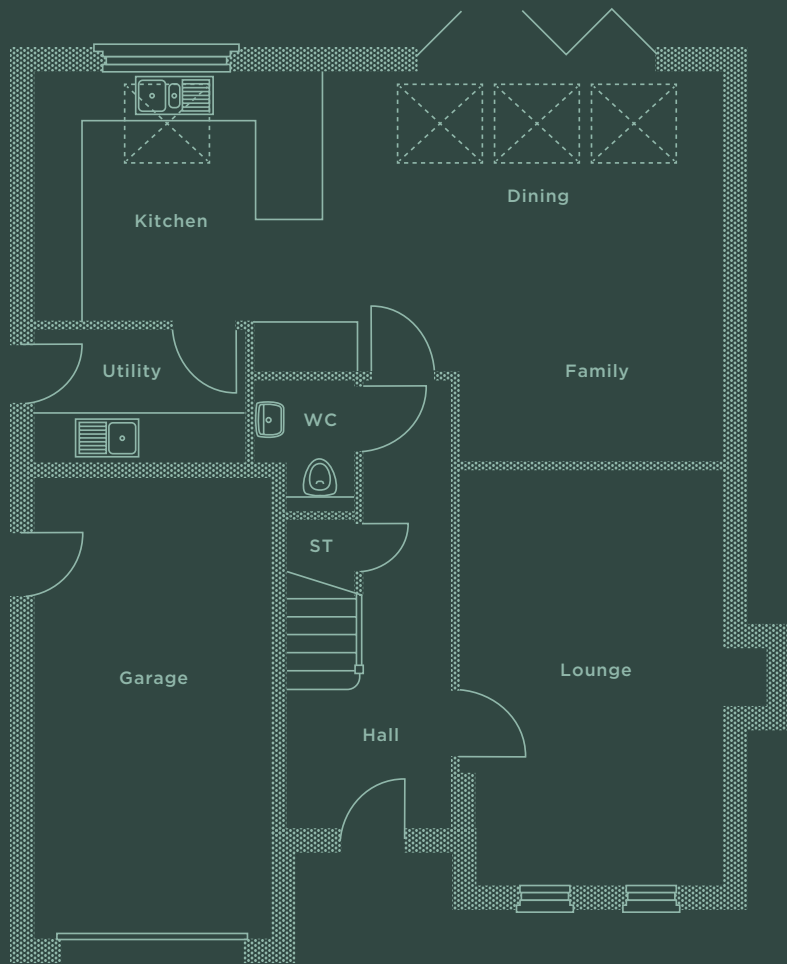

Downstairs

Lounge	3325 x 5270mm 10'11" x 17'3"
Kitchen/Dining/ Family	8790 x 4950*mm 28'10" x 16'3"*
Utility	2670 x 1650*mm 8'9" x 5'5"*
Cloaks/WC	1275 x 1660*mm 4'2" x 5'5"*
Garage	3015 x 6000*mm 9'11" x 19'8"*

Upstairs

Bedroom 1	3375 x 4085*mm 11'1" x 13'5"*
En-suite 1	2360 x 1590mm 7'9" x 5'3"
Bedroom 2	3115 x 2790mm 10'3" x 9'2"
En-suite 2	3115 x 975mm 10'3" x 3'2"
Bedroom 3	3375 x 3275*mm 11'1" x 10'9"*
Bedroom 4	3120 x 2890*mm 10'3" x 9'6"*
Bathroom	2135 x 1880*mm 7'0" x 6'2"*

*Denotes maximum room dimensions.

