

# SHELBOURNE

— ESTATES —



## The Willingham

Blending traditional charm and architecture with an impressive entrance hall and a generous open plan kitchen area, spacious, contemporary interior, combined with living areas that flow seamlessly throughout creating wonderful entertaining spaces and everything you look for in the family home of today, and more.

4 Bedrooms

1,424 TOTAL SQ FT

## Downstairs

Lounge	3300 x 6025mm 10'10" x 19'9"
Kitchen/ Family/Dining	5175* x 6265*mm 17'0"* x 20'7"*
Utility	3000 x 1625mm 9'10" x 5'4"
Cloaks/WC	2725 x 1170mm 8'11" x 3'10"

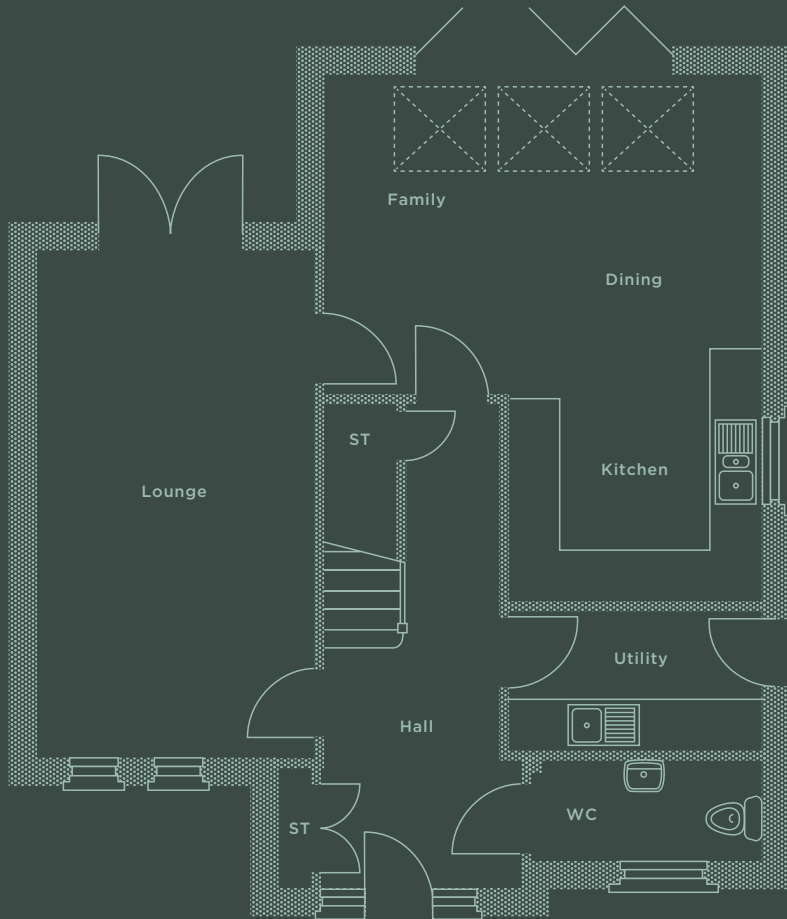

## Upstairs

Bedroom 1	3350 x 4025mm 11'0" x 13'2"
En suite 1	2390 x 1915mm 7'10" x 6'3"
Bedroom 2	2775 x 3760*mm 9'1" x 12'4"*
Bedroom 3	2775* x 4010*mm 9'1"* x 13'2"*
Bedroom 4	3285 x 1910mm 10'9" x 6'3"
Bathroom	2890 x 1860*mm 9'6" x 6'1"*

\*Denotes maximum room dimensions.

